

AMERICAN BANK CENTER ARENA  
PROMOTERS GUIDE  
& TECH PACK

2023-2024

AmericanBank  CENTER

AmericanBank  CENTER

VENUE  
*by the bay*

[WWW.AMERICANBANKCENTER.COM](http://WWW.AMERICANBANKCENTER.COM)

1901 N. SHORELINE BLVD, CORPUS CHRISTI, TX 78414

 | 

# Table of Contents

CENTER OVERVIEW.....	3
ARENA UPGRADES & CAPACITIES.....	4
GENERAL DIRECTORY.....	5
BOOKING & EVENT MANAGEMENT.....	6
RENTAL DEAL STRUCTURE.....	7
SHOW EXPENSES EXAMPLE.....	8
MARKETING & PUBLIC RELATIONS.....	9
BUILDING SPECIFICS.....	10-11
VENUE PARKING & EMERGENCY ROUTE.....	12
ARENA FLOOR PLANS, SHOW MERCH, SUITES...	13-17



*I have corpus vibes...*  
**VENUE BY THE BAY**

On behalf of OVG360 and OVG Hospitality at American Bank Center, we look forward to serving as your host to create a remarkable experience for your guests!



# Welcome to Corpus Christi, Texas

American Bank Center is an entertainment complex owned by the city of Corpus Christi and managed by OVG360 with OVG Hospitality. The complex is located in downtown Corpus Christi, Texas and **consists of an arena, auditorium, and convention center.** The facility hosts numerous conventions, trade shows, exhibitions, live performances and sporting events. Located directly on the beautiful Corpus Christi bay downtown, American Bank Center is flexible for any group offering complimentary Wi-Fi, premium food and beverage options. With over 138,000 sq. ft. of multi functional exhibit hall and 180,250 sq. ft. of Arena space, American Bank Center is the ideal venue for concerts, conferences or conventions.

## Location

Corpus Christi is located near Texas three largest cities.

## Market Size

Corpus Christi, Texas: 320k+  
Coastal Bend: 550k+  
(Aransas Pass, Portland, North Padre Island)

## PRIMARY ETHNICITIES

- 31.6% Caucasian
- 64% Hispanic

## SOLD OUT SHOWS

- Reba
- Chris Stapleton
- Jason Aldean
- New Kids on the Block
- Elton John
- Incubus

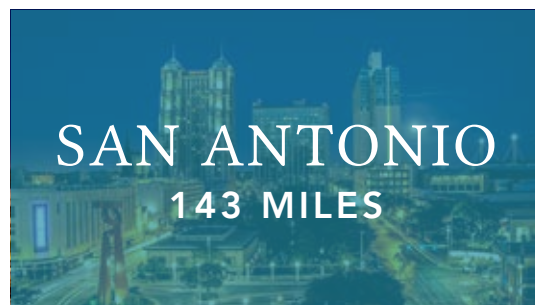

For booking inquiries please contact Joey Trevino, Booking Manager at 361.826.4754 or email at [Joey.Trevino@oakviewgroup.com](mailto:Joey.Trevino@oakviewgroup.com)

# Arena Upgrades & Capacities

## AMERICAN BANK CENTER UPGRADES

- Removal of facade allowing stage to move back 20' and increase 180 capacity by 1,100
- Loading Dock expansion increased by 8,000 sq.ft. and added 3rd bay
- Upper bowl curtain enclosure reducing capacity to 4,000-5,000
- Locker room/dressing room renovations
- New State of the art video board (center hung) with halo
- Fascia/ribbon boards
- New sound system and sound board

(18) SH96 Danley SoundLabs Loudspeakers

(6) DBH218 Danley SoundLabs Subwoofers

(3) SH46 Danley SoundLabs Speakers

QSC I/O Frame Audio Processors

Danley SoundLabs DNA20K4 Pro Amplifiers

Allen & Heath SQ-6 Mixer

## Arena Size

180,250 sq. ft.

## Convention Center Size

147,600 sq. ft.

## Approximate Arena Seating Capacities

Hockey - 7,728

Basketball - 8,280

Center Stage - 10,000

End Stage - 8,750

Half House Variable for Show

## Architects

Project Architects

Thompson, Ventulett,

Stainback & Associates,

Arquitectonica, Gignac &

Associates

## Website

[www.americanbankcenter.com](http://www.americanbankcenter.com)



# General Directory



Main Line	361.826.4700
Front Desk Security	361.826.4743
Command Security	361.826.4764
Arena Box Office	361.826.4744
Auditorium Box Office	361.826.4745

Daniel Melise  
**General Manager**



Daniel.Melise@  
oakviewgroup.com

Cynthia Woods  
**General Manager**



Cynthia.Woods@  
oakviewgroup.com

Joey Trevino  
**Booking Manager**

Joey.Trevino@  
oakviewgroup.com

Jeff Elledge  
**Box Office Manager**

Jeff.Elledge@  
oakviewgroup.com

DeAnna Richarte  
**Director of Marketing**

DeAnna.Richarte@  
oakviewgroup.com

Jeff Butcher  
**Director of Operations**

Jeff.Butcher@  
oakviewgroup.com

OPEN  
**Director of  
Event Services**

Sheree Worthington  
**Director of Finance**  
Sheree.Worthington@  
oakviewgroup.com

Travis Gallier  
**Director of Global  
Partnerships**  
TGallier@  
oakviewgroup.com

Courtney Richter  
**Production Manager**

Courtney.Richter@  
oakviewgroup.com

Bailey Ayers  
**Event Manager**

Bailey.Ayers@  
oakviewgroup.com

**Venue Address**  
1901 N. Shoreline Blvd  
Corpus Christi, TX  
78414

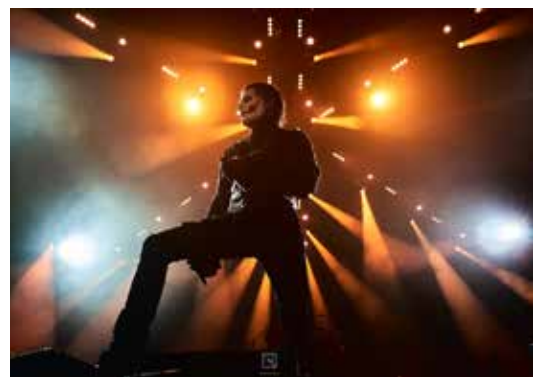



# Booking & Event Management

## BOOKING PROCEDURES

### **Scheduling Date**

Those with questions regarding the availability of dates should contact the Booking Manager.

### **Rental Expense**

Rental structure is based on established rental rates and determined by the type of event and space used. Further information can be obtained from the Booking Manager.

### **Contract Execution**

All arrangements are considered to be tentative until a license agreement has been fully executed and returned. A deposit may be required upon execution of license agreement to secure your date.

### **Financial Settlement**

At the conclusion of the event, the licensee is responsible for settling all outstanding facility expenses. Any questions regarding the settlement procedure should be directed to the General Manager.

### **Event Management**

From the moment your event becomes contracted, an Event Manager will be assigned to be your primary contact with our facility. Your Event Manager is your principal source of information and can be your "right hand" once you have arrived on site. The Event Manager will take the information provided by your team and disseminate it to the appropriate facility personnel. As the proper information is provided, your Event Manager will work with our entire team to ensure your event is a success.



# Rental Deal Structure

Please Contact the Booking Manager  
or Event Manager for Prices

- Rent and Misc. Expenses (3.50%)
- Rent
- Credit Card Fees
- Furnishings - Rent a Center
- Forklift - United Rentals
- CO2 - Matheson & IFS
- Passenger Vans - Enterprise
- Runners - Antares
- Catering Assistants - Antares
- Catering - American Bank Center
- Security - American Bank Center & Nueces  
County Sheriff Office
- Port-A-Johns CC Rentals
- Cargo Van - U-haul
- Ambulance - Medivan EMS
- Refrigerator - Mission



## Show Expenses Example

### RENT/HOUSE NUT \$50,000

Full House, \$40,000 (No Upper Bowl)

#### Includes

- Event Staff/Ushers
- Box Office
- Housekeeping
- Parking
- Operation Labor
- Entry/General Security
- House EMT
- House Police

#### Does Not Include

- Stagehands  
(Per Truck) \$5,000
- Runners
- Show Expenses
- Production
- Catering
- Show Requested EMT
- Show Requested Security
- Show Requested Police

- Stagehands  
(Per Truck) \$5,000
- Facility Fee/Local Taxes 8.25%
- Credit Card Fees 3.5%
- Facility Fee \$4
- Ticketing: Ticketmaster
- Merch 80%/20% Soft, 90%/10% Hard/Books Venue Sells

### RENT/HOUSE NUT STRUCTURE \$8,500

\$8,500 vs. 12.5% of Net Ticket Sales, capped at \$12,000

#### Includes

- Event Staff/Ushers
- Box Office
- Housekeeping
- Parking
- Operation Labor
- Entry/General Security
- House Police

#### Does Not Include

- Stagehands  
(Per Truck) \$3,500
- Runners
- Show Expenses
- Production
- Catering
- EMT
- Show Requested Security
- Show Requested Police

- Stagehands  
(Per Truck) \$3,500
- Facility Fee/Local Taxes 8.25%
- Credit Card Fees 3.5%
- Facility Fee \$4
- Ticketing: Ticketmaster
- Merch 80%/20% Soft, 90%/10% Hard/Books Venue Sells







# Marketing & Public Relations

American Bank Center marketing department acts as an in-house advertising agency and can assist with the promotion of your show through a multitude of channels. Along with promoting your event through in-venue assets, the marketing department has a competitive edge when it comes to purchasing local media including TV, radio, digital, print and outdoor on your behalf.

## VENUE MARKETING

- Digital
- Print
- OOH
- Media
- Public Relations

## SOCIAL MEDIA

-  @americanbankctr | 7.8k+
-  American Bank Center | 53k+
-  @americanbankcenter | 11k+
-  americanbankcenter.com | 2.4k+
-  Fans First Subscriber E-blast 165k+

## ADDITIONAL MARKETING RESOURCES

- Inclusion in Monthly Email Newsletter
- Distribution of Press Releases to Local Marketing Contacts
- Coordination of Trade Advertising with Local Online and Radio Partners
- Event Promotion and Contests via social Media Channels
- Promotional Announcements, Static Images during TAMUCC Men's & Women's Basketball and Corpus Christi IceRays hockey games

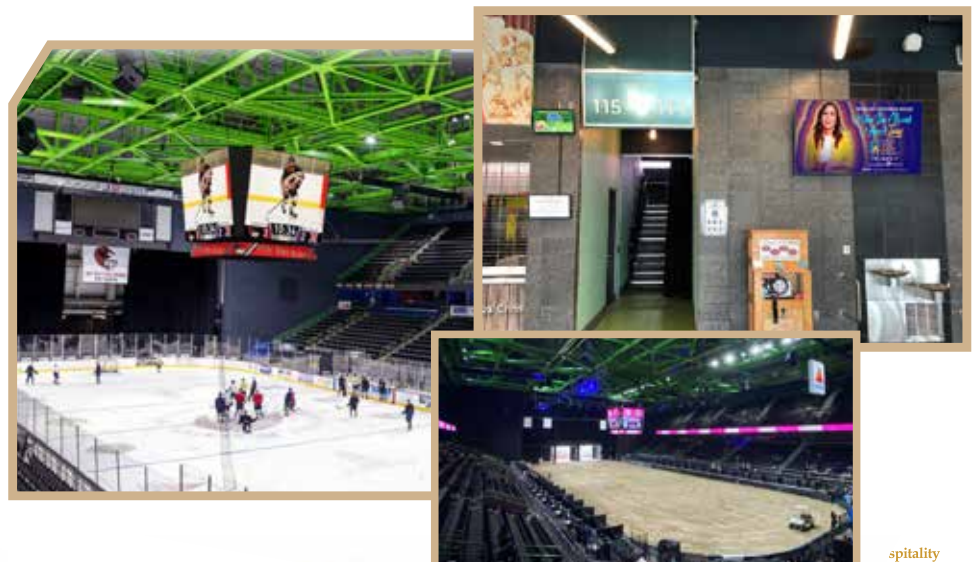

# Building Specifics

## Loading Docks

American Bank Center has a 15-grid system that is positioned 62' from the floor. The maximum weight permitted on the end stage grid is 130,000 pounds of evenly distributed weight and 76,000 for a center stage show. The facility provides a fall protection system, and all safeties must be adhered to. The Event Manager must receive all weight loads in advance. Your Event Manager can provide additional rigging information by request.

## Scoreboard, Video, Ribbon Boards

- Center Hung - 13' 7.8" Tall x 17'8" Wide Corner Panels (Non-Backlit) Approx. 11'5.25" x 3'2.25"
- Ribbon Boards 2.46' x 210.04'

## Sound System and Communication

Shure SM58 handheld wired mics and two Beta87 handheld wireless mics are available upon request. Two-channel Clear-Com communications are also available. Patch panels located around the arena include XLR, BNC and Clear-Com (XLR) connections. The audio/video control room is located on the second level above section 106.

## Spotlights

American Bank Center has 4-Super Troopers.

## Stagehand Labor

The facility uses Antares Staging and Rigging for production use. Contact your Event Manager to connect.

## Staging

The facility features a "Stage Right" Stage and Barricade (80'). Sections are 4'x8' (150) with a black tech-stage surface. Accessories included are accessible ramp, stairs, skirting and guardrails. The standard mixer stage is a 12' x 24' platform with heights ranging from 8"-24".

## Telecommunications

Phones and fax lines may be set in almost any area of the facility. All orders for phone line installation must be received by your Event Manager a minimum of 5 days prior to your event.

## Television Production Power and Cabling

Various gang boxes and junctions are available in the Arena. Contact the building technical representative or your Event Manager for specific information pertaining to your needs.

## Dressing Rooms

4 rooms (Locker Rooms) 1 Star Room with 4 closed door bathroom/showers

## Production Parking

Show parking at American Bank Center is located in the loading dock, which is located off N Chaparral St. on the west side of the building. Prior to the event, please coordinate all parking requirements with your Event Manager.

### **Facility Fee**

All tickets are subject to facility and maintenance fee. The fee is typically \$4 per ticket for all ticketed events. The fee must be included in the advertised ticket price.

### **Concessions/Catering/Alcohol**

Services are provided exclusively by Oak View Group Hospitality, which offers food and beverage services to satisfy any taste and any group size. Please contact Oak View Group Hospitality prior to your event for a catering quote. If you wish to provide your own catering please discuss the catering buyout fee with venue Event Manager. Per our liquor license, all alcohol on the property must be provided by Oak View Group Hospitality.

### **Merchandising**

The right to sell any merchandise, product or other item must be coordinated through venue Event Manager. The sale of any and all merchandise is prohibited without prior approval. A percentage of sales will be collected by the venue at the conclusion of the event.

### **Pyro**

Allowed with permit. Lessee, at its sole expense, shall be responsible for pyro permit(s). Contact venue Event Manager at least ninety (90) days in advance to an event needing pyro.

### **Sales Tax**

8.25%; all ticketed admissions and equipment rentals are subject to tax.

### **Security**

Event Manager will coordinate uniformed police officers and contracted security personnel based on your events needs. It is the policy of American Bank Center to hand-held wand every patron and check every bag.

### **Solicitations**

No collection or donation whether for charity or otherwise, shall be made, attempted or announced on the premises without the written approval of management of the Complex.

### **Ticketing & Box Office**

Ticketmaster is the exclusive ticket seller for all American Bank Center events. The ticket office requests your event information a minimum of two weeks prior to the on sale. Please contact our Box Office Manager.

**Box Office Hours:** Monday–Friday 10am–6pm. Open Saturdays & Sundays 2 hours prior to show time on event days only.

### **Rigging**

American Bank Center has a 15-grid system that is positioned 62' from the floor. The maximum weight permitted on the stage grid is 120,000 pounds of evenly distributed weight and 76,000 for a center stage show. The facility provides a fall protection system and all safeties must be adhered to. The Event Manager must receive all weight loads in advance. Your Event Manager can provide additional rigging information by request.



# Venue Parking

## PARKING

Show parking at American Bank Center is located in the loading dock off Chaparral St. on the west side of the building. Prior to the event, please coordinate all parking requirements with your Event Manager.



## Emergency Route

### CHRISTUS Spohn Hospital Corpus Christi

Shoreline (LEVEL II TRAUMA)  
600 Elizabeth St. Corpus Christi, TX 78404  
(2.3 miles from venue)  
Phone (361) 881-3000 | ER OPEN 24hrs

### Corpus Christi Fire Station 1

514 Belden St., Corpus Christi, TX 78401  
(.08 miles from venue)  
Phone (361) 826-8054



# Arena Floor

## CONCOURSE 1ST FLOOR

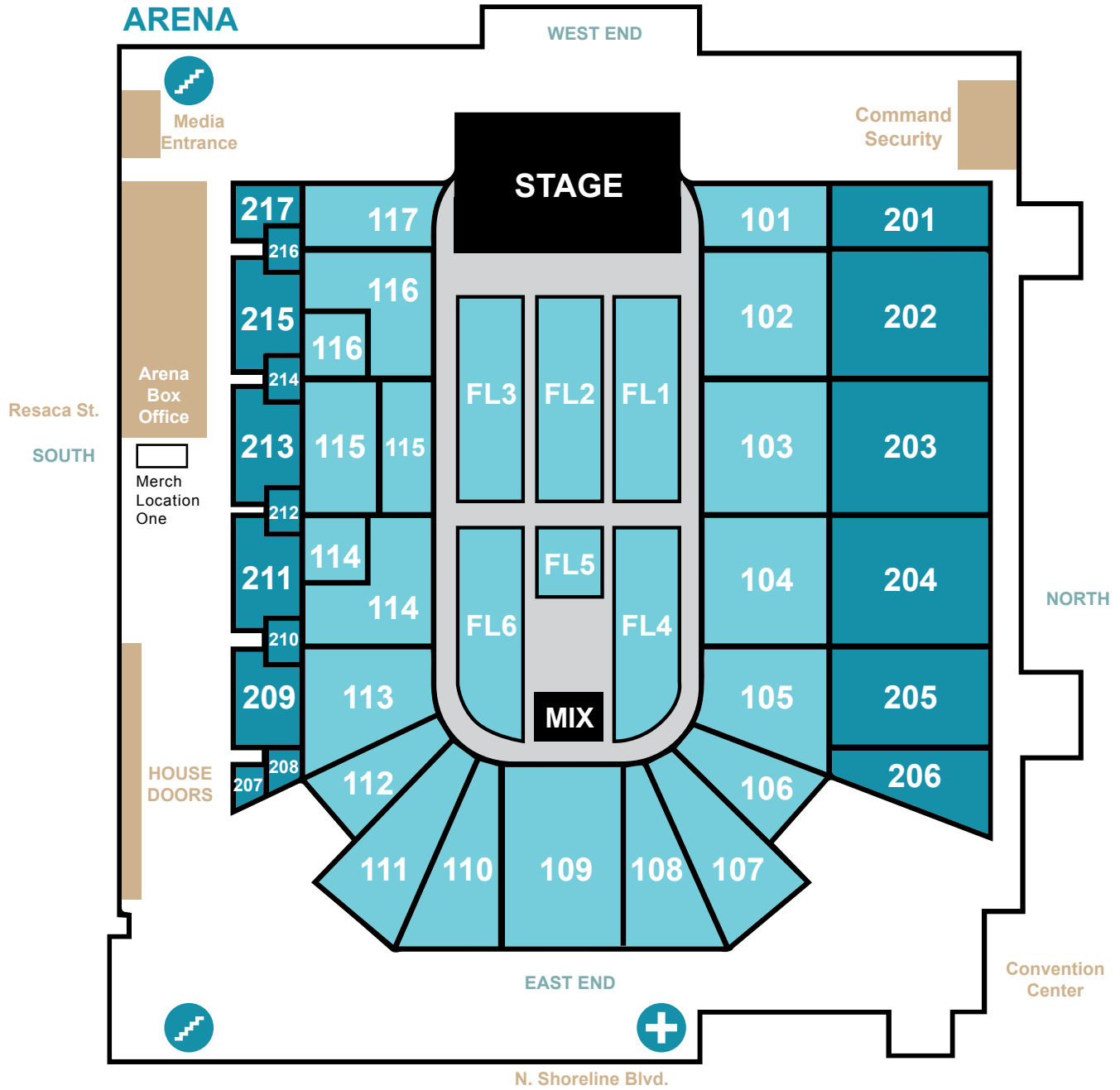

# Arena Floor

FULL HOUSE Typical End Stage 180, 210, 240

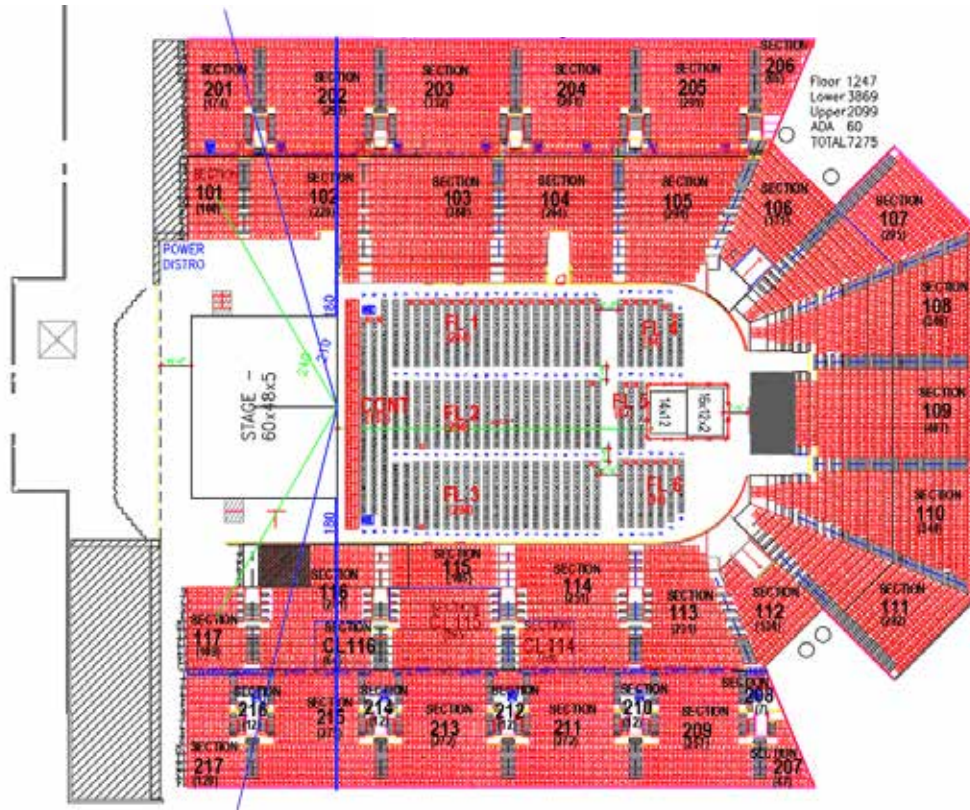

# Arena Floor

HALF HOUSE Half House Configuration

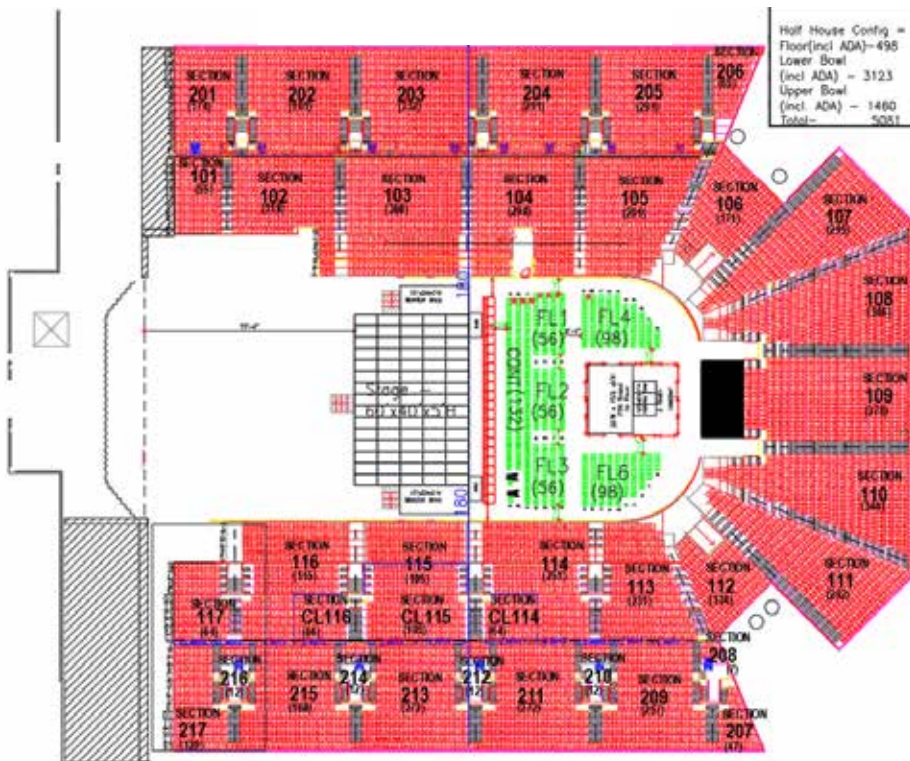



# Arena

## STEEL AND CATWALK OVERLAYS

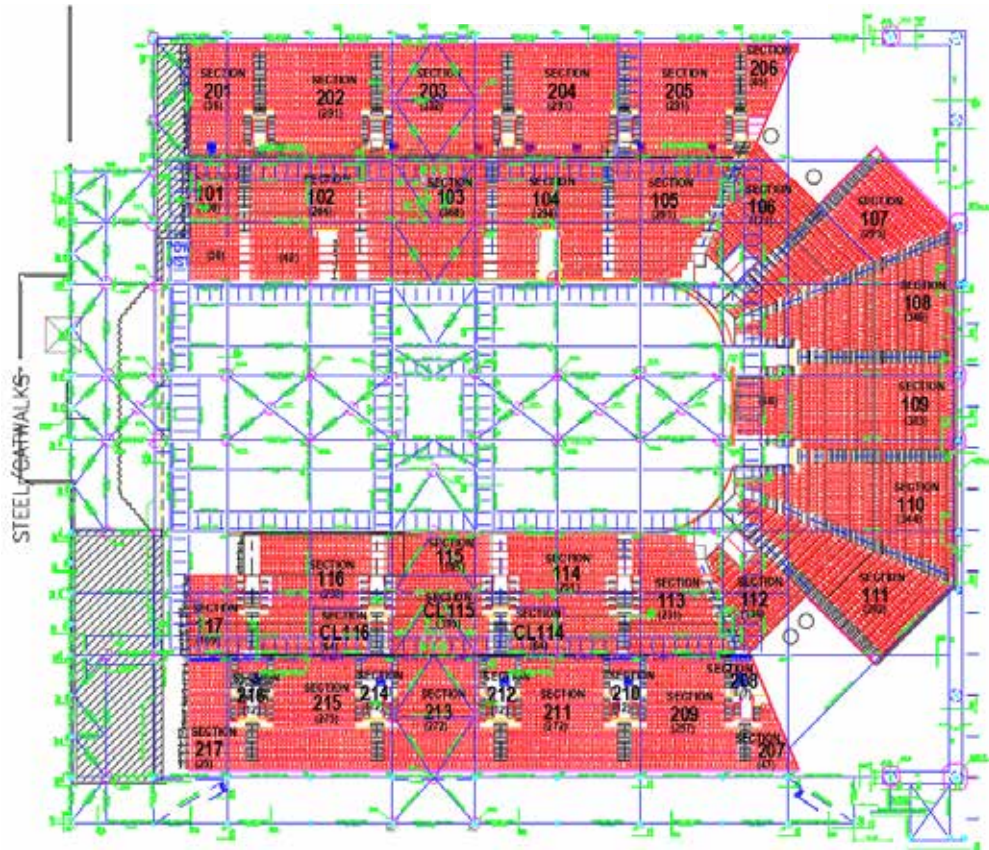

## SUITES

Luxury & Premium Seating sold by our experienced OVG360 Premium Department.

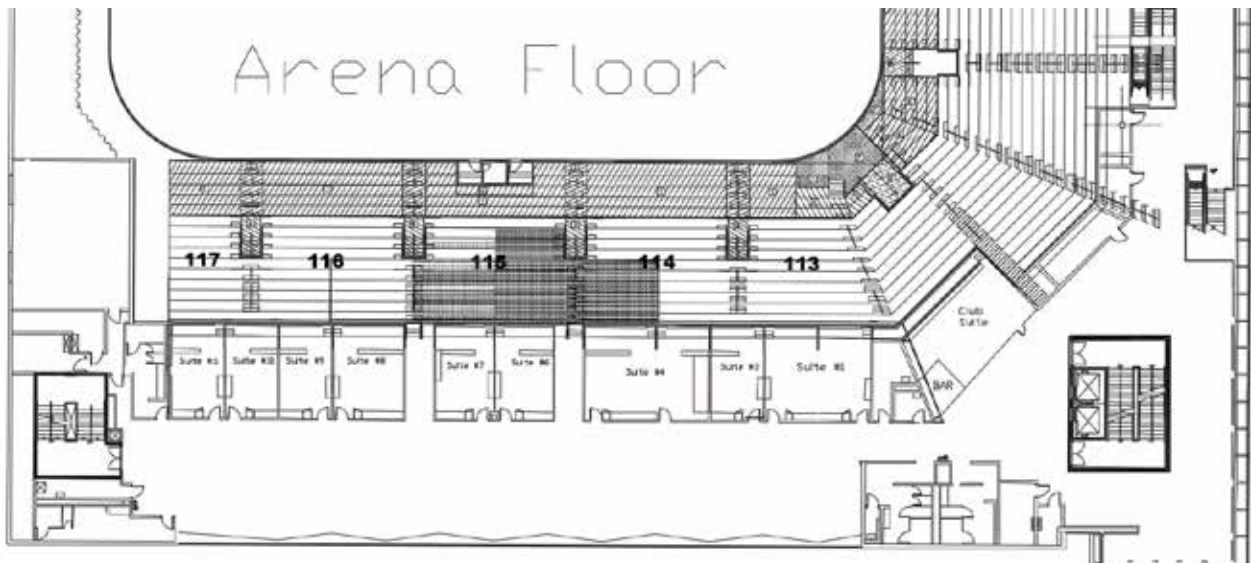

# Arena Floor

## SHOW POWER

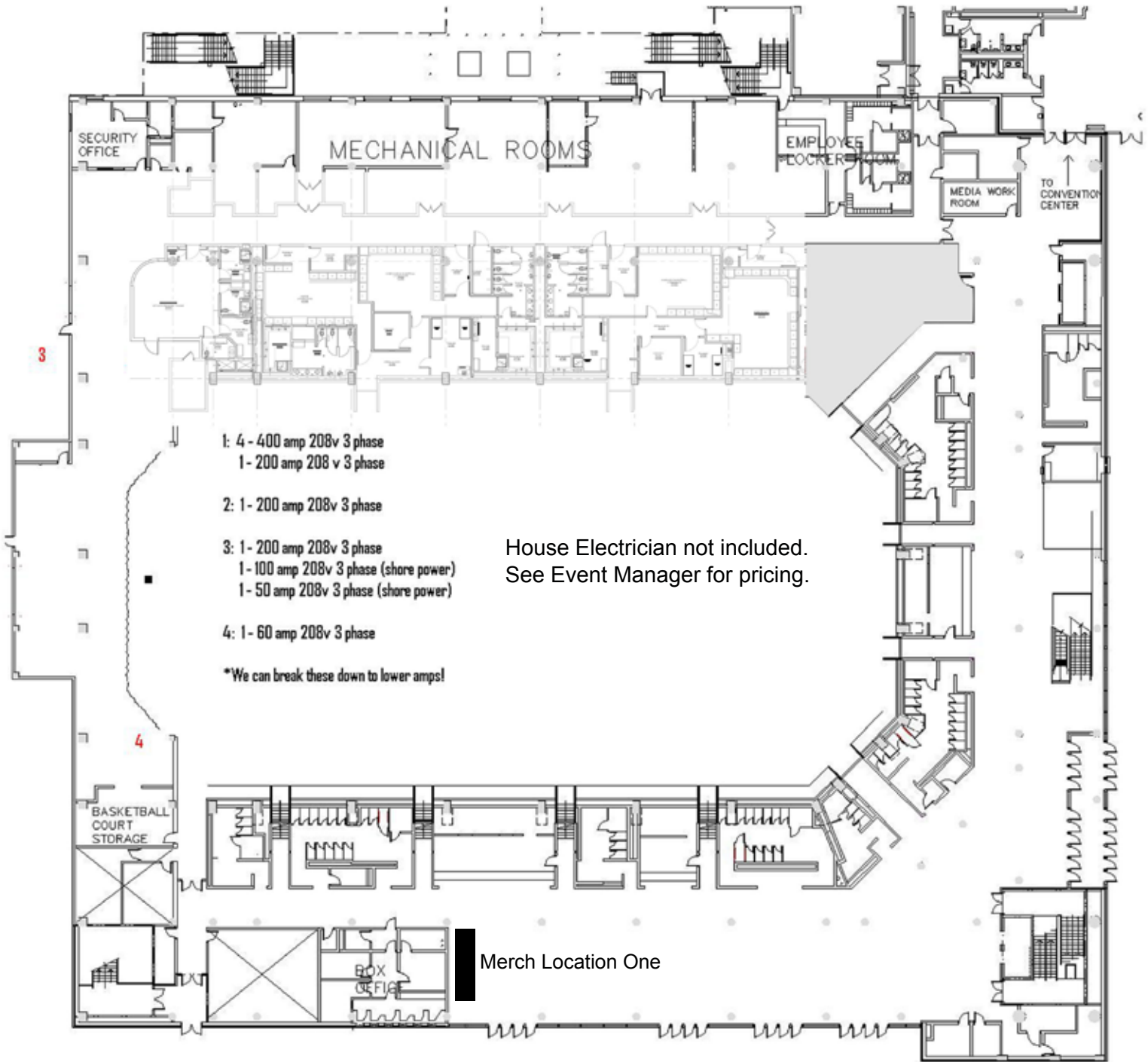



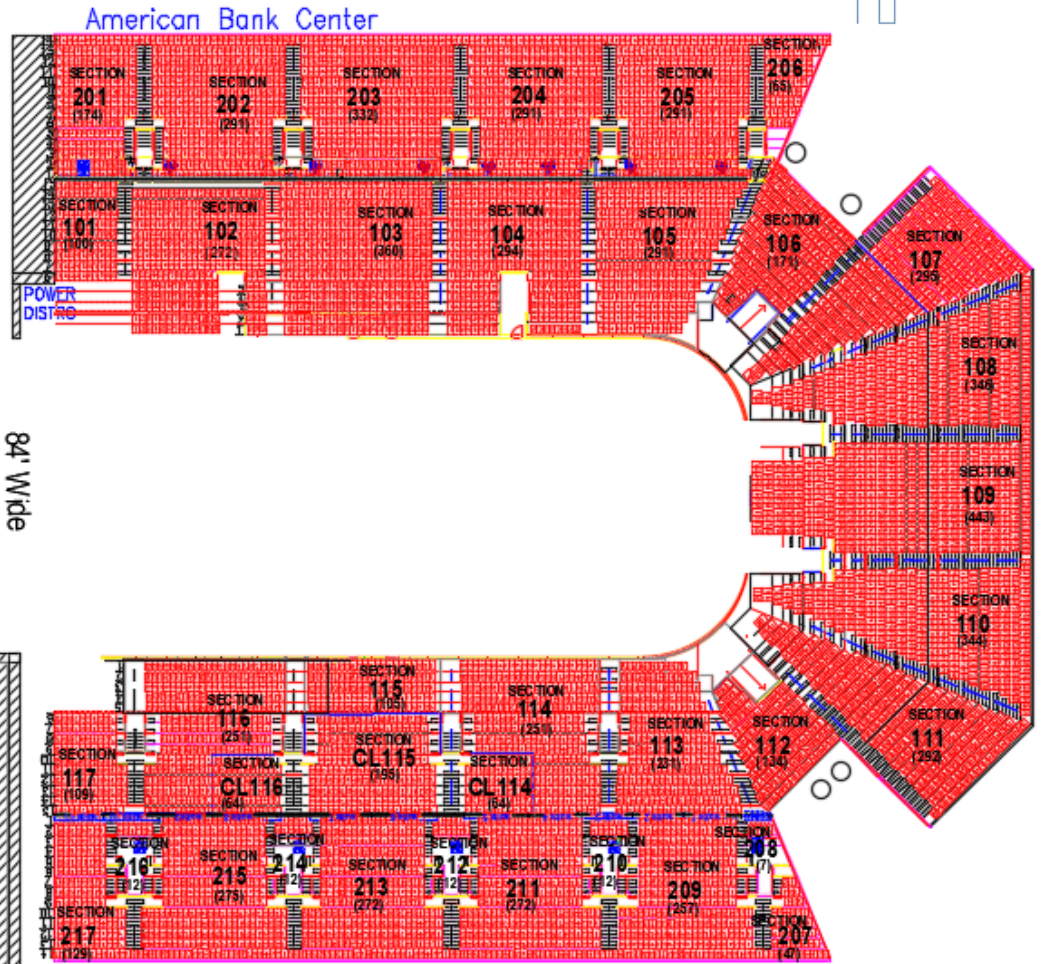
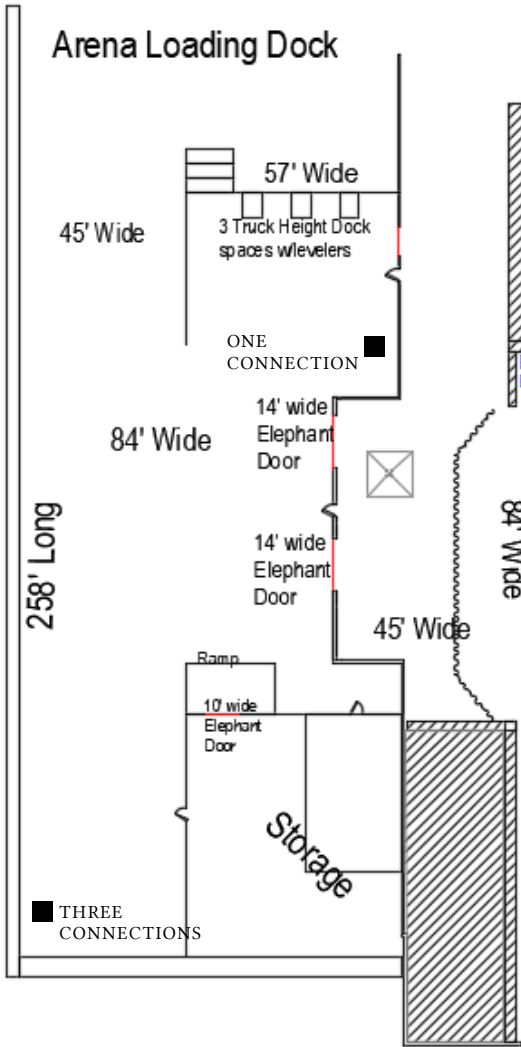
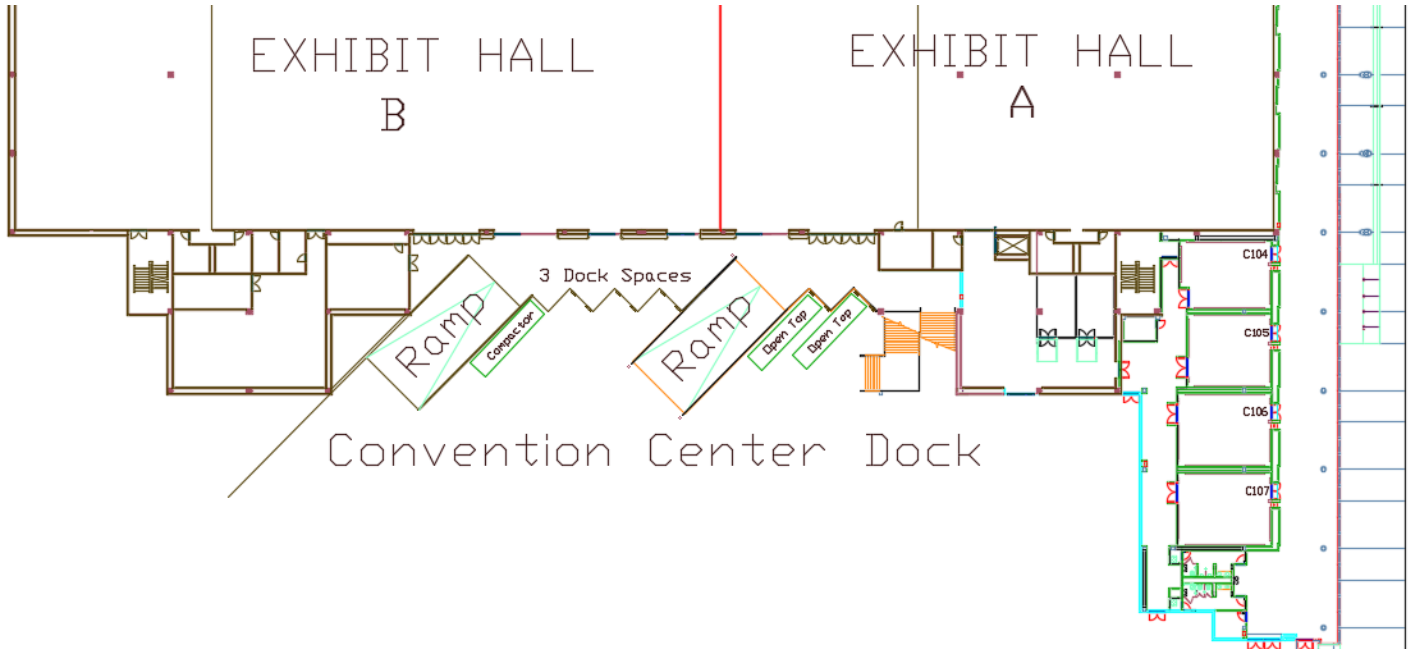

■ 4 SHORE POWER CONNECTIONS